

Plugs and sockets for reefer containers



On ships and
at terminals.

„Time is money. Connection in no time thanks to the slanted plug-in direction and the DUO interlocking.“

Safe connection.
Worldwide.



Container-professional

Specialist

MENNEKES is the specialist in the field of plugs and sockets for reefer containers on ships and at terminals. Our product range comprises receptacles, plugs and connectors as well as receptacle combinations, available either in plastic or stainless steel. Of course we can also offer you customised solutions specially geared towards your demands. Please contact us!

Plastic and stainless steel housings

Only MENNEKES offers you the choice between stainless steel and plastic enclosures for receptacle combinations. Both materials are suited for application on ships as well as at terminals.



Your selection:
Plastic or stainless steel.

Proven a million times over

MENNEKES plugs and sockets have proven themselves a million times over in everyday application even under extreme conditions. Users throughout the world appreciate the reliability and durability of MENNEKES products.



Tested safety

Internationally standardised plugs and sockets for reefer container: Earth contact at 3 o'clock position in accordance with IEC 309-2/EN 60309-2, protection type $\Delta\Delta$ IP 67.

400-
440V
3h
3P+⊕



Stainless steel receptacle

New!



combinations

Stainless steel receptacle combinations for connecting reefer containers on ships and at container terminals are available with two up to ten switched interlocked DUO receptacles 400-440V, 32A, 4p, earth contact at 3 o'clock position. Robust and durable enclosure made of stainless steel (material 1.4301) protect the electronic components from mechanical and environmental influences. Upon request, we can also manufacture the enclosures in stainless steel (material 1.4404).



Stainless steel
receptacle
combinations:
Custom-tailored
solutions or
standard devices.

Easy, fast and clear

Fast connections save time: easier plug-in and withdrawal thanks to the slanted plug-in direction. With one turn, the plug is locked and the receptacle activated. Less screws mean less work. This allows you to open and close the combination unit quickly.



Space-saving

The slanted plug-in direction allows the space-saving alignment of several enclosures on top of each other. This eases planning and construction.



Variable cable entry

Cable entry through cable gland in any position at the bottom or at the side.



Easy to install

The large connection space facilitates the insertion and connection of large cable diameters.



Easy control

Time-saving and helpful: easy to detect switch position thanks to the clear switch position display of the proven DUO interlocking.

AMAXX[®] plastic receptacle

Highest degree
of variability.
Practice-conform
solutions.



combinations

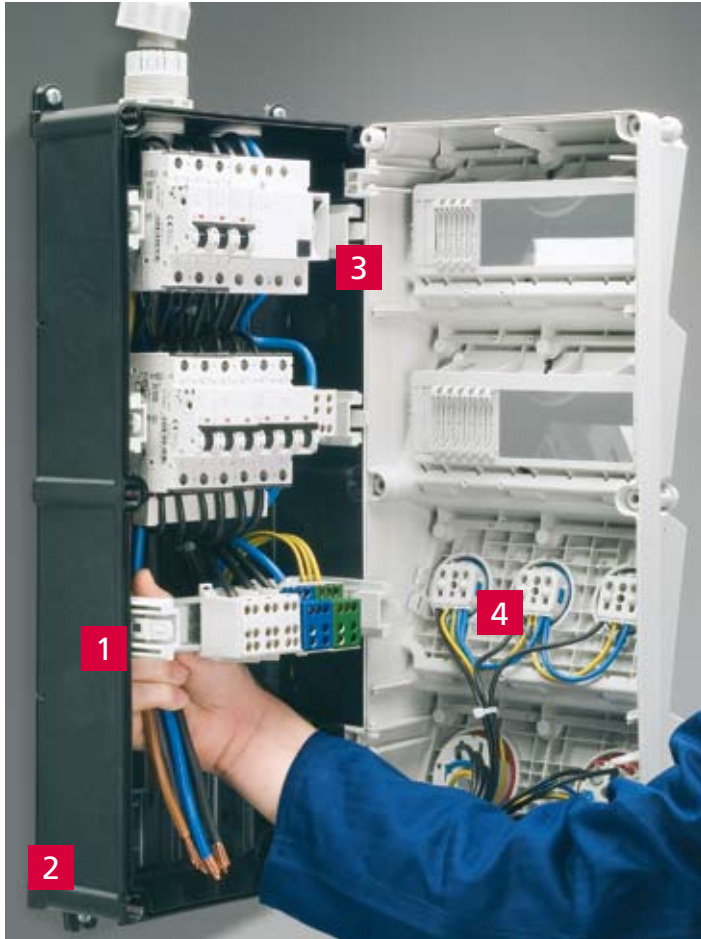

AMAXX® receptacle combinations consist of robust enclosures made of the special plastic AMAPLAST used by MENNEKES. Available from a single DUO interlocked receptacle up to combinations with five modules which can be fitted with three DUO receptacles and fusing. They are expandable by flanging the combinations vertically or horizontally.

1 Lifiable DIN Rails

Lifiable DIN rails and a large, smooth wiring space significantly ease the insertion as well as connection of large cables.

2 One-man installation

Shorter installation times with the new, user-friendly external fixing.

3 Hinged cover

The hinged cover, which opens on the side, eases connection work.

4 Ready for application

All combinations are pre-wired for installation and tested for electric safety and quality.



AMAXX®
plastic receptacle
combinations:
Custom-tailored
solutions or
standard devices.



Generally angled insertion direction.



Especially fast opening and closing of the enclosure due to captive double-threaded cover screws.



Standard pre-punched cable entries on the top and the bottom for M20 up to M40.



Window can be locked with a padlock, enclosure can be sealed.

Receptacles, plugs, connec

Proven technology.
Safe connection.



ctors



AM-TOP® plugs and connectors

Stable enclosure consisting of one part. The teeth on the cable gland secure a safe grip and protect against loosening. The cable gland serves as an anti-bend protection for the cables at the same time.

Proven a million times over on ships and at container terminals.

Switched and interlocked receptacles

Receptacles with the patented, mechanical DUO interlocking ensure that the receptacle can only be switched when inserting a plug.



Tight and durable

Safety for all enclosures thanks to foamed seals: silicone, CFC and halogen-free. The permanently elastic seals ensure protection type IP 67 even after years of use.



Secure contact

Nickel-plated contacts and highly heat-resistant contact carriers provide optimum protection against corrosion and overheating.



The switch is locked in the OFF position.

The plug can only be inserted and withdrawn if the switch is in the OFF position. The switch can only be turned to ON when a plug is inserted in the receptacle.



The plug is locked in the ON position.

To remove the plug with the switch in ON position is not possible.

CEE receptacle combinations made of stainless steel for reefer containers

32A, 4-polig, 400-440V, earthing contact in the 3 o' clock position
in accordance with DIN VDE 0623, EN 60309-2.

Enclosure made of stainless steel (material 1.4301), powder-coated grey (RAL 7035), protection type $\Delta\Delta$ IP 67,
cable entry M32 up to M63, with circuit breaker 10kA. Receptacles, switched and interlocked, DUO,
with highly heat resistant contact carrier and nickel-plated contacts, made of AMAPLAST.

For customized solutions which are especially made for your applicaton. Please contact us!



**Stainless steel receptacle combination
with 2 receptacles DUO**

Part no. 6002814

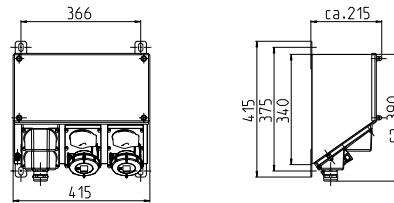

**Stainless steel receptacle combination
with 3 receptacles DUO**

Part no. 6002827

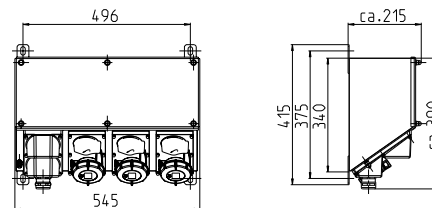

**Stainless steel receptacle combination
with 4 receptacles DUO**

Part no. 6002830

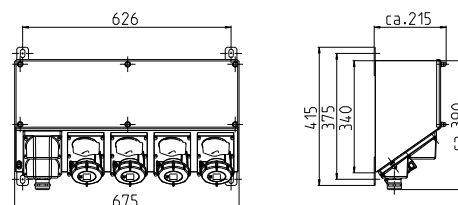

**Stainless steel receptacle combination
with 5 receptacles DUO**

Part no. 6002846

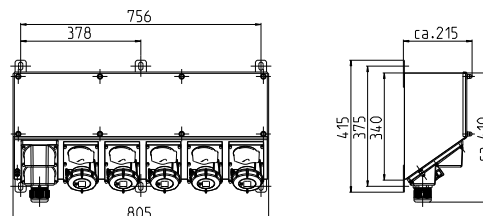

**Stainless steel receptacle combination
with 6 receptacles DUO**

Part no. 6002859

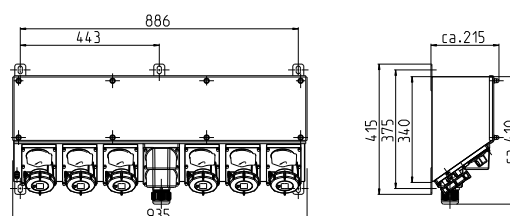

CEE receptacle combinations made of stainless steel for reefer containers



Plugs for the world

32A, 4-polig, 400-440V, earthing contact in the 3 o' clock position
in accordance with DIN VDE 0623, EN 60309-2.

Enclosure made of stainless steel (material 1.4301), powder-coated grey (RAL 7035), protection type Δ IP 67,
cable entry M32 up to M63, with circuit breaker 10kA. Receptacles, switched and interlocked, DUO,
with highly heat resistant contact carrier and nickel-plated contacts, made of AMAPLAST.

For customized solutions which are especially made for your applicaton. Please contact us!



**Stainless steel receptacle combination
with 7 receptacles DUO**

Part no. 6002862

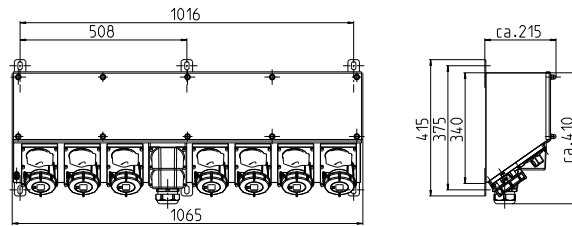

**Stainless steel receptacle combination
with 8 receptacles DUO**

Part no. 6002875

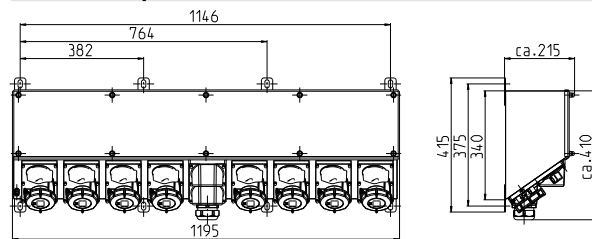

**Stainless steel receptacle combination
with 9 receptacles DUO**

Part no. 6002888

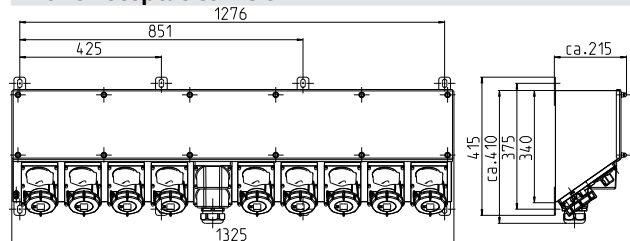

**Stainless steel receptacle combination
with 10 receptacles DUO**

Part no. 6002891

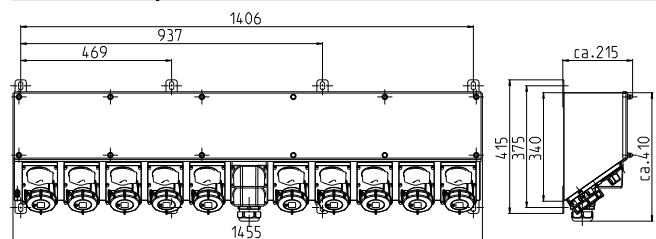

**Lid,
with rivet and spring
for receptacle**

41580



Circuit breaker 32A, 3p, AC, 440V

Icu=10kA
Icu=25kA
Icu=50kA

**4995425
4995426
4995427**



**Module plate with receptacle
32A, 4p, 400-440V, 3h
switched and interlocked**

41581

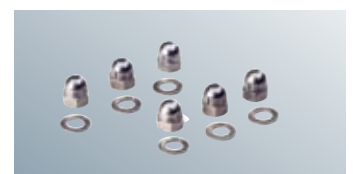

**Screw set:
6 bow nuts and washers**

**M5 for mounting plate 41582
M8 for cover 41583**

AMAXX® receptacle combinations made of plastic for reefer containers

32A, 4-polig, 400-440V, earthing contact in the 3 o' clock position,
acc. DIN VDE 0623, EN 60309-2 and IEC 309-2.

Made of AMAPLAST, bottom part black, top part grey (RAL 7035), hinged to the side, protection type $\Delta\Delta$ IP 67.

Receptacles, switched and interlocked, DUO, with highly heat resistant contact carrier and nickel-plated contacts.

For customized solutions which are especially made for your applicaton. Please contact us!



Enclosure size H x W x D

130 x 225 x 227 mm

Enclosure size H x W x D

260 x 225 x 227 mm

Enclosure size H x W x D

390 x 225 x 227 mm

Enclosure size H x W x D

520 x 225 x 236 mm

Cable entry

2 x M25 each on top and
bottom

Additionally: 2 x M 20 each
on top and bottom to cut out.

Cable entry

2 x M32 each on top and
bottom

Additionally: 2 x M 20 each
on top and bottom to cut out.

Cable entry

2 x M40 each on top and
bottom

Additionally: 2 x M 20 each
on top and bottom to cut out.

Cable entry

2 x M40 each on top and
bottom

Additionally: 2 x M 20 each
on top and bottom to cut out.

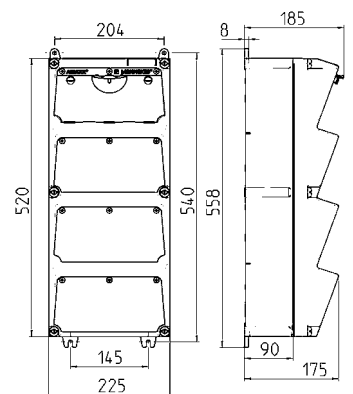
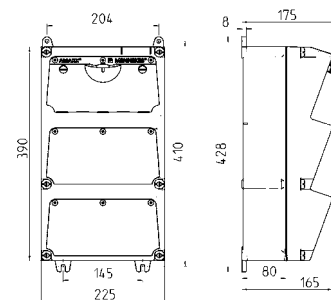
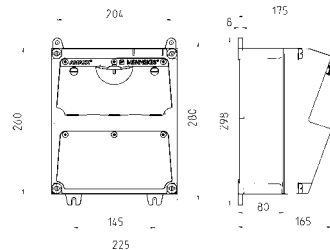
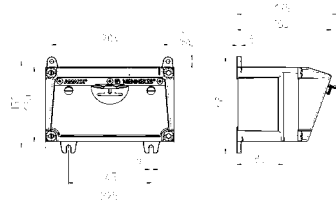

AMAXX® receptacle combinations made of plastic for reefer containers



Plugs for the world

32A, 4-polig, 400-440V, earthing contact in the 3 o' clock position,
acc. DIN VDE 0623, EN 60309-2 and IEC 309-2.

Made of AMAPLAST, bottom part black, top part grey (RAL 7035), hinged to the side, protection type Δ IP 67.

Receptacles, switched and interlocked, DUO, with highly heat resistant contact carrier and nickel-plated contacts.

For customized solutions which are especially made for your applicaton. Please contact us!



AMAXX® receptacle combinations with 3 receptacles DUO

fusing under a transparent cover.

Fitted with: 3 CEE receptacles 32A, 4p, 400-440V, 3h,
switched and DUO interlocked
3 MCB's 32A, 3p, C
earth bolt M10, V2A

Enclosure size H x W x D 520 x 225 x 236 mm

Cable entry 2 M40 at the top (open on the left side, on the right closed)
2 M40 at the bottom (closed), 2 M20 at the top closed,
2 M20 at the bottom (closed),
terminal for 1 cable 5 x 25 mm²

Part no. 940027



AMAXX® receptacle combinations with 3 receptacles DUO and monitoring sockets

fusing under a transparent cover.

Fitted with: 3 CEE receptacles 32A, 4p, 400-440V, 3h,
switched and DUO interlocked
3 MCB's 32A, 3p, C
3 monitoring sockets sim. to MS 3102E 14S2S
with protection cap and steel chain, earth bolt M10, V2A

Enclosure size H x W x D 520 x 225 x 236 mm

Cable entry 2 M40 at the top (open on the left side, on the right closed)
2 M40 at the bottom (closed), 2 M20 at the top closed,
2 M20 at the bottom (closed), terminal for 2 cables
5 x 25 mm², terminal 4 x 4 mm² for 3 monitoring sockets

Part no. 940019



AMAXX® cable glands

black RAL 9005,
individual packed

M20
for cable from 6-13 mm

Part no. 990607
for IP 67 + O-ring 20405000

M32
for cable from 13-21 mm

Part no. 990608
for IP 67 + O-ring 20425000

M40
for cable from 14-28 mm

IP 67: Part no. 990609



CEE plugs and sockets for reefer containers

32A, 4-polig, 400-440V, earthing contact in the 3 o' clock position
in accordance with DIN VDE 0623, EN 60309-2.

Enclosure and insert made of AMAPLAST, colour: electric grey and/or colour code, protection type ⚡ IP 67.

Other versions available on request.



Receptacle
with highly heat resistant contact carrier and nickel plated contacts, 4 external fixings, one cable entry at top and one blind cable entry (can be cut out) at bottom

Part no. 2644

Drawing	Amp.	32
1 MB 219	Poles	4
Dim. in mm	a	120
	b	112
	c	143
	d	90,2
	e	79
	e1	98,5
	f	5,5
	g	5
	h	160
	M	32
	M*	(blind)
		to be cut out
	Max. cable diam. (mm)	25
	Terminal for cond. cross section (mm²) min.-max.	2,5
		10

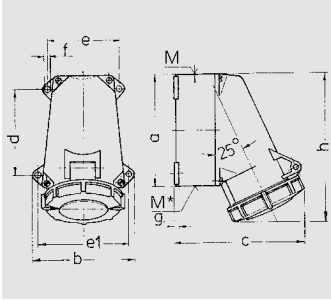

Receptacle
with highly heat resistant contact carrier and nickel plated contacts, switched, with mechanical DUO interlock, may be padlocked in the OFF position

Part no. 5792

Drawing	Amp.	32
1 MB 207	Poles	4
Dim. in mm	a	225
	b	118
	c	152
	d	208
	e	101
	f	6,3
	g	8
	h	268
	M	1x25
	M*	1x32
		2x25
	Max. cable diam. (mm)	25
	Terminal for cond. cross section (mm²) min.-max.	2,5
		10

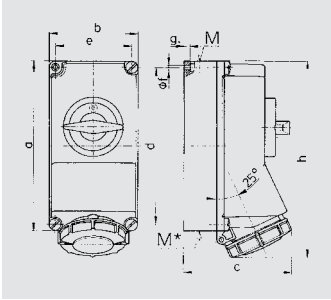

Receptacle
with highly heat resistant contact carrier and nickel plated contacts, switched, with mechanical DUO interlock and DIN rail, may be padlocked in the OFF position

Part no. 5946

Drawing	Amp.	32
1 MB 181	Poles	4
Dim. in mm	a	364
	b	134
	c	168
	d	347
	e	117
	f	6,3
	g	8
	h	408
	M	32
	M*	40
	Max. cable diam. (mm)	27
	Terminal for cond. cross section (mm²) min.-max.	2,5
		10

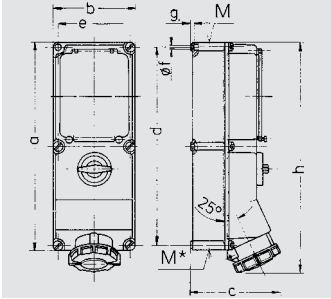

Panel mounted receptacle
with highly heat resistant contact carrier and nickel plated contacts

Part no. 2123

Drawing	Amp.	32
1 MB 141	Poles	4
Dim. in mm	a	85
	b	75
	c	70
	d	60
	e	60
	f	5,5
	g	8
	g.1	2
	h	99
	i	103
	k	34
	l	62
	Terminal for cond. cross section (mm²) min.-max.	2,5
		10

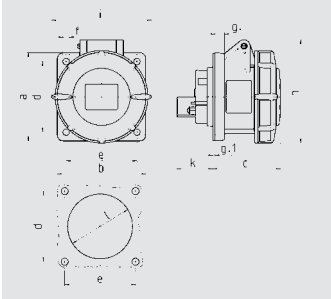

CEE plugs and sockets
for reefer containers

32A, 4-polig, 400-440V, earthing contact in the 3 o' clock position
in accordance with DIN VDE 0623, EN 60309-2.

Enclosure and insert made of AMAPLAST, colour: electric grey and/or colour code, protection type $\blacktriangle\blacktriangle$ IP 67.

Other versions available on request.



Plug AM-TOP®
with highly heat resistant
contact carrier and nickel
plated contacts, single part
body, screw terminals, cable
gland and sealing

Part no. 2175

Drawing	Amp.	32
2 MB 218	Poles	4
Dim. in mm	a	186
	b	94
	n	145
	y	22
Terminal for cond. cross		2,5
section (mm ²) min.-max.		6

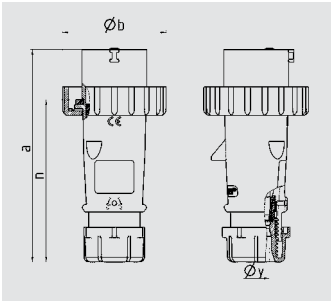

Connector AM-TOP®
with highly heat resistant
contact carrier and nickel
plated contacts, single part
body, screw terminals, cable
gland and sealing

Part no. 2177

Drawing	Amp.	32
3 MB 62	Poles	4
Dim. in mm	a	212
	b	96
	h	98
	y	22
Terminal for cond. cross		2,5
section (mm ²) min.-max.		6

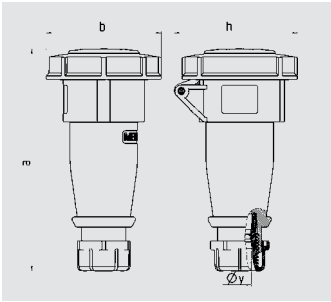

Panel mounted inlet
with highly heat resistant
contact carrier and nickel
plated contacts, with hinged
lid

Part no. 2692

Drawing	Amp.	32
2 MB 40	Poles	4
Dim. in mm	a	85
	b	85
	c	141
	d	70
	e	70
	f	6,2
	g	6
	g.1	2
	h	181
	s	93
	l	30
Terminal for cond. cross		2,5
section (mm ²) min.-max.		10

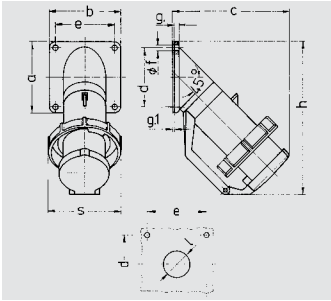

MENNEKES
Elektrotechnik GmbH & Co. KG
Industrial plugs and sockets

Aloys-MENNEKES Str. 1
D-57399 Kirchhundem

Tel. + 49 (0) 27 23 / 41-1
Fax + 49 (0) 27 23 / 41-2 14
E-Mail info@MENNEKES.de
Internet www.MENNEKES.de

International branches / representations

CN China
NANJING MENNEKES Electric
Appliances Co., Ltd.
58 Qinhuai Road
Jiangning Development Zone
PRC-211100 Nanjing
PR China
Tel. + 86 (0) 25 / 52 12 55 66
Fax + 86 (0) 25 / 52 12 55 77
E-Mail info@MENNEKES.com.cn
Internet www.MENNEKES.com.cn

F France
MENNEKES
Electrotechnique France SARL
Z.I. de Leveau – Porte F
F-38200 – VIENNE
Tel. + 33 (0) 4 / 37 02 24 10
Fax + 33 (0) 4 / 74 53 41 39
E-Mail mef@MENNEKES.fr
Internet www.MENNEKES.de

UK Great-Britain
MENNEKES Electric Ltd.
Unit 4, Crayfields Industrial Park
Main Road, St. Pauls Cray
Orpington
Kent BR5 3HP, UK
Tel. + 44 (0) 16 89 / 83 35 22
Fax + 44 (0) 16 89 / 83 33 78
E-Mail info@MENNEKES.co.uk
Internet www.MENNEKES.co.uk

RI Indonesia
MENNEKES
Elektrotechnik GmbH & Co. KG
(Indonesia Representative Office)
Graha Mustika Ratu 10th Floor
Jl. Jend. Gatot Soebroto Kav. 74-75
Jakarta 12870
Tel. + 62 (0) 21 / 835 20 80-81
Fax + 62 (0) 21 / 835 20 82
E-Mail sales@MENNEKESindo.com

IND India
MENNEKES
Elektrotechnik GmbH & Co. KG
(India Representative Office)
No. 2 A, Gowthami Towers
Cenotaph Road, 1 St. Street
600018 Teynampet, Chennai
India
Tel. + 91 (0) 44 243 158 - 50
Fax + 91 (0) 44 243 158 - 53
E-Mail suresh@MENNEKES.de

I Italy
MENNEKES Electric Italia s.r.l.
Piazza Garibaldi 1
I-21021 Angera (VA)
Tel. + 39 03 31 / 210 827
Fax + 39 03 31 / 932 133
E-Mail info@MENNEKES.it
Internet www.MENNEKES.it

SGP Singapore
MENNEKES
Electric Singapore Pte. Ltd.
No. 3 International Business Park
03-28 Nordic European Centre
SGP-Singapore 609927
Tel. + 65 / 65 67 59 78
Fax + 65 / 65 63 24 71
E-Mail info@MENNEKES.com.sg

THA Thailand
MENNEKES
Elektrotechnik GmbH & Co. KG
(Thailand Representative Office)
26/4 Sukhumvit 64 Rd.
Bangchack Prakhonong
Bangkok 10260, Thailand
Tel. + 66 (0) 2 / 741 5266
Fax + 66 (0) 2 / 741 5267
E-Mail suphamit@MENNEKES.de

USA United States of America
MENNEKES Electrical Products
277, Fairfield Road
USA-Fairfield, N.J. 07004
Tel. + 1 973 / 882-83 33
Fax + 1 973 / 882-55 85
E-Mail info@MENNEKES.com
Internet www.MENNEKES.com

Further representatives in
more than 80 countries
around the world.

**Service by
MENNEKES®.**
Always well informed.