

Industrial Ethernet



**Industrial Ethernet
by MENNEKES.**
Energy and data.

"Finally, there is a complete solution for local industrial data networks."

All from
one source.



Data transfer

You are familiar with MENNEKES as competent provider of high-quality industrial plugs and sockets. One current example are our AMAXX® receptacle combinations.

Based on this competence and the close cooperation with our customers, we have developed a new compact solution for energy and data on the basis of AMAXX®.

The result: a modular system that combines energy and data technology.

Easily planned, calculated and ordered

- All energy and data components from one source.
- Complete solution instead of individual installations.

Modular structure

- Equipped with standard network components.
- Easy retrofitting or expansion.

Clearly arranged and appealing

- Elegant and robust AMAXX® enclosure system.
- Also available in yellow.
- Compact design.



Clear installation advantages

- Shorter installation times.
- Less material required.
- Fast installation of the enclosures.

Suitable and safe for industrial needs

- Protected against dust, moisture and other environmental influences.
- Protection degrees IP 44 and IP 67.
- Physical separation of network and energy enclosure.

Industrial network

System solutions
suited for
industrial needs.

Industrial Ethernet allows the utilization of the Ethernet standard for networking devices in industrial production. With Industrial Ethernet, you can incorporate devices required for coordination and control of production processes into the present Ethernet network.



Industrial Ethernet by MENNEKES is optimally suited for establishing local networks or sub-networks in rough industrial environments. Wherever data and electricity are required in production or logistics – for example in the incoming goods department or on field level (machine sector) or in dispatch. And both indoors and outdoors. With industrial ethernet by MENNEKES individual installations, special solutions and overdimensioned distribution cabinets are things of the past.

Administration

Main server

OWG

Production

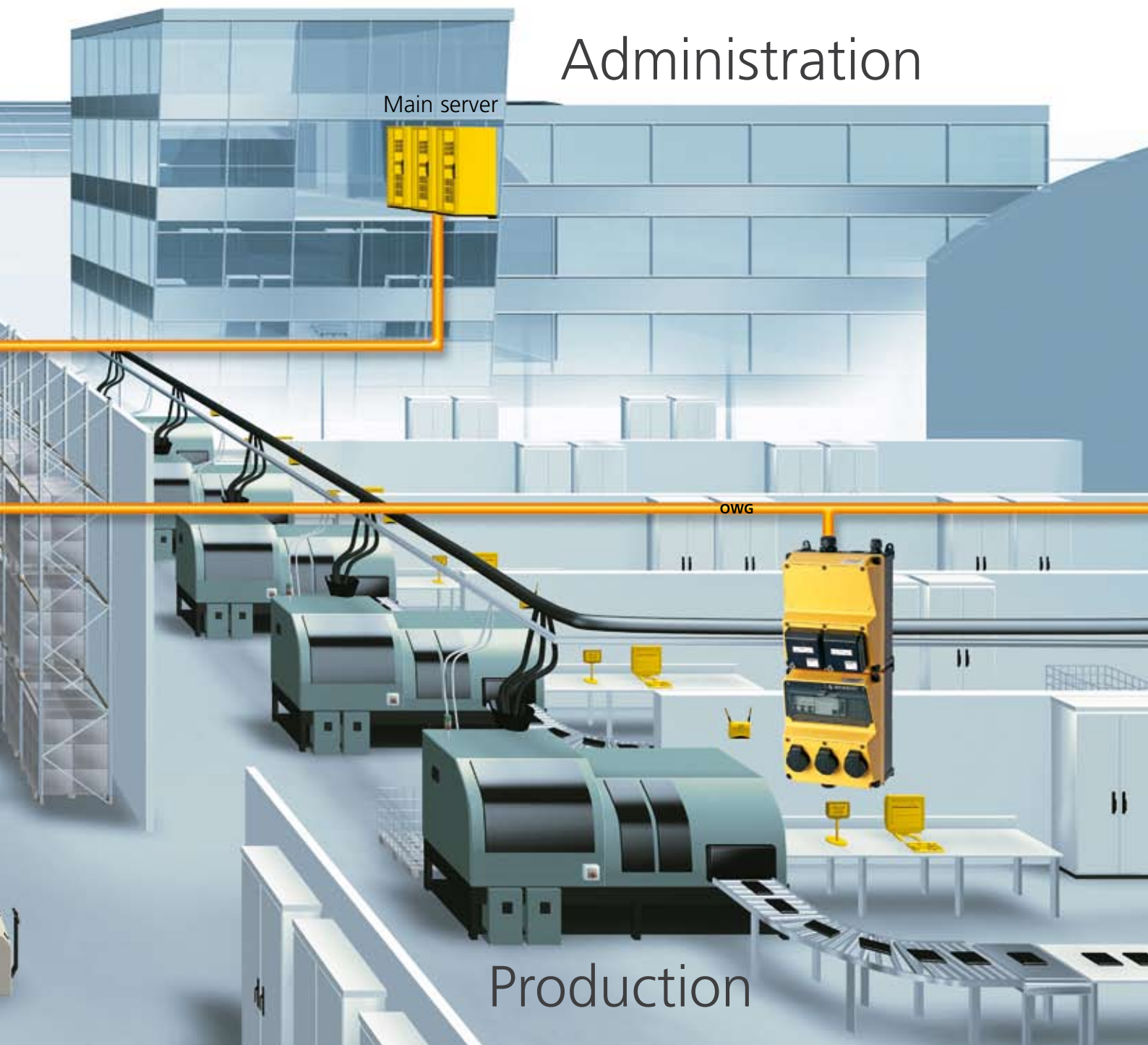

Application example: incoming goods

In the network enclosure:

- Fibre optic cable (OWG) bundles can be connected through the splice cassettes and distributed to 6 OWG couplers SC/ST duplex.
- 1 OWG output is used for additional network enclosures in production.
- 4 OWG outputs free (reserve).
- 6-port Ethernet switch for DIN rail installation with OWG port (ST, MM).
- 1 short-circuit proof switching power supply 24V for DIN rail installation (power supply for switch).
- 4 RJ45 Cu ports led through via lockable Cepex data port receptacles.
- 1 RJ45 Cu port led through via separate lead for external connection (e.g. AirKRAFT®).



Network enclosure

Energy enclosure

Industrial network in detail

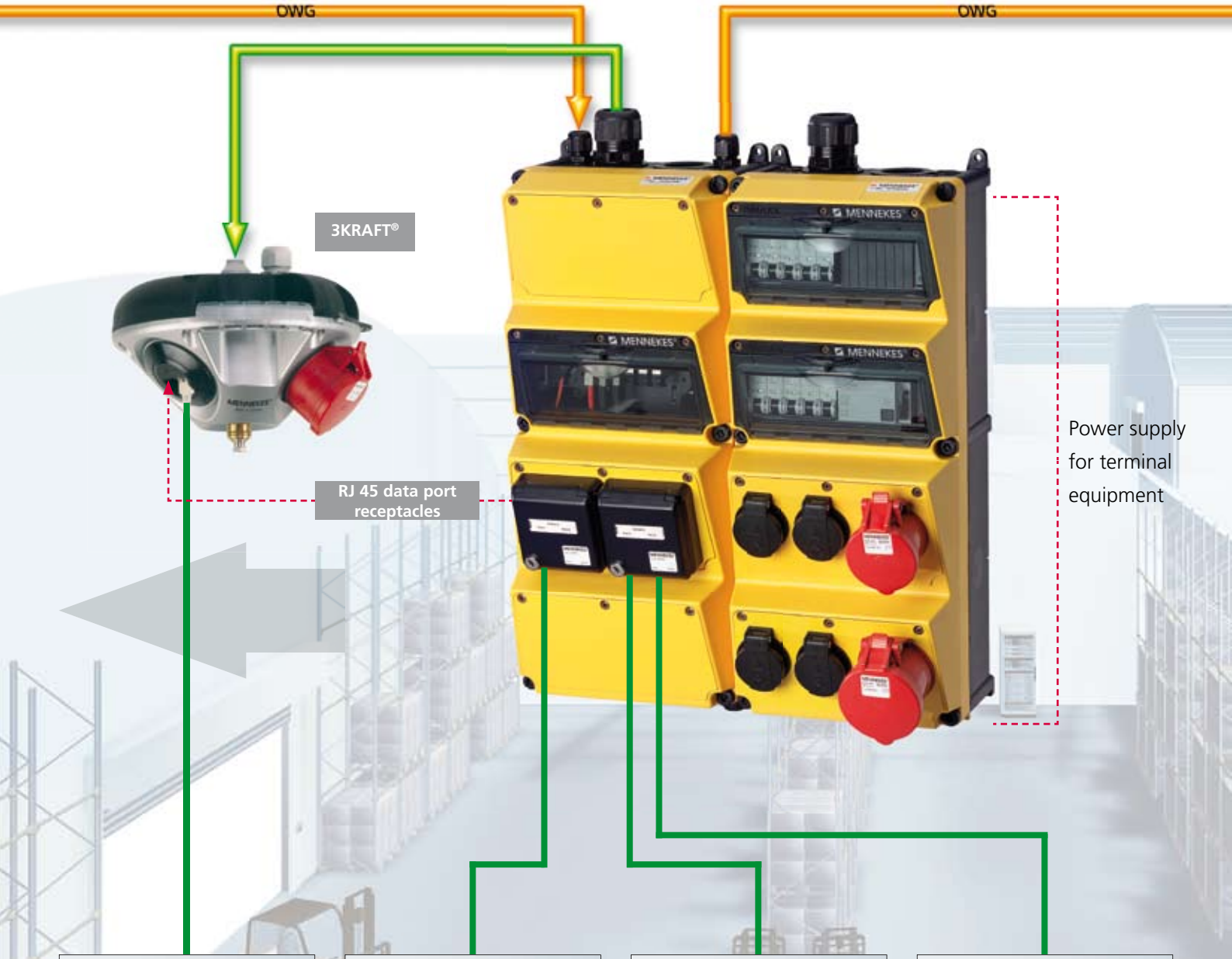

Electronic measuring equipment for quality control



PC for incoming goods bookings



Printer for storage receipts



Label printer for weight notes

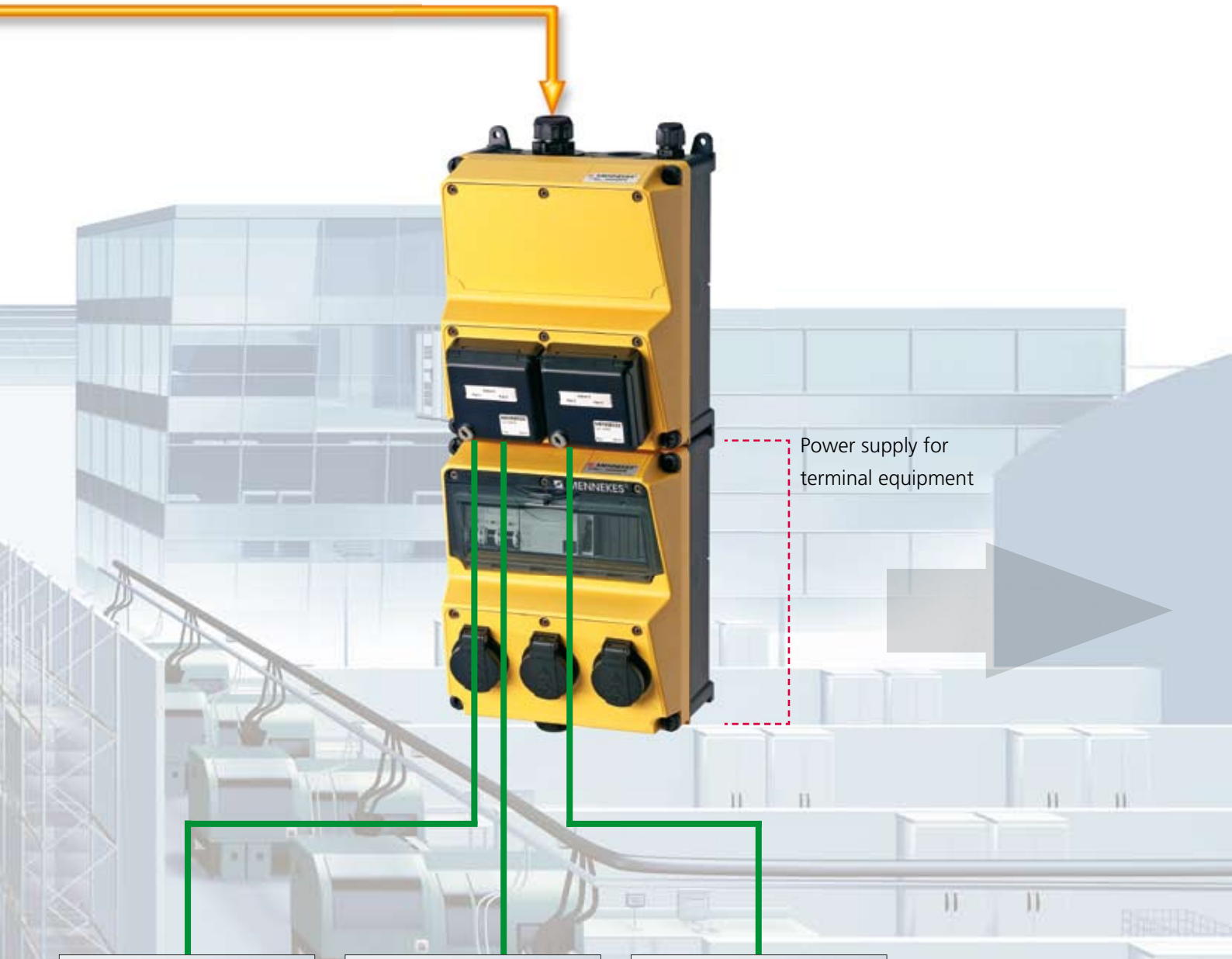

Power supply for terminal equipment



Electronic scale with electric supply



Modem for remote machine maintenance



Touch screen BDE terminal

Application example: production



Network enclosure

Energy enclosure

In the network enclosure:

- 1 ready-made 4-fibre OWG breakout cable with ST plugs.
- 2 OWG fibres with ST plugs are located as reserve in the bottom part of the enclosure.
- 3-port Ethernet switch for DIN rail installation with OWG port (ST, MM).
- 1 short-circuit proof switching power supply 24V for DIN rail installation (power supply for switch).
- 3 RJ45 Cu ports led through via lockable Cepex data port receptacles.

Advantages at a glance:

- Physically separated enclosures with hinged top part.
- Standard pre-punched cable inserts.
- Cable gland set with several seal inserts for variable cable insertion.
- External data access via lockable Cepex data port receptacles possible.
- External installation by one single fitter.

Variable

Fitted easy
and fast.

Industrial Ethernet by MENNEKES can be fitted variably with network components like switches, OWG splice cassettes, patch fields and data port receptacles. Distributors and data interfaces are led through via RJ45 data module connectors, which allow the application of ready-made patch cables. Numerous sophisticated details like seal inserts with multiple perforations for cable entry complement the system offer.

Module board with 3 data port receptacles BTR V6 E-DAT



Module board with 3 data port receptacles BTR V4 bulkhead



Module board with 2 Cepex data port receptacles



Module board with 3 data port receptacles Harting type Han 3A

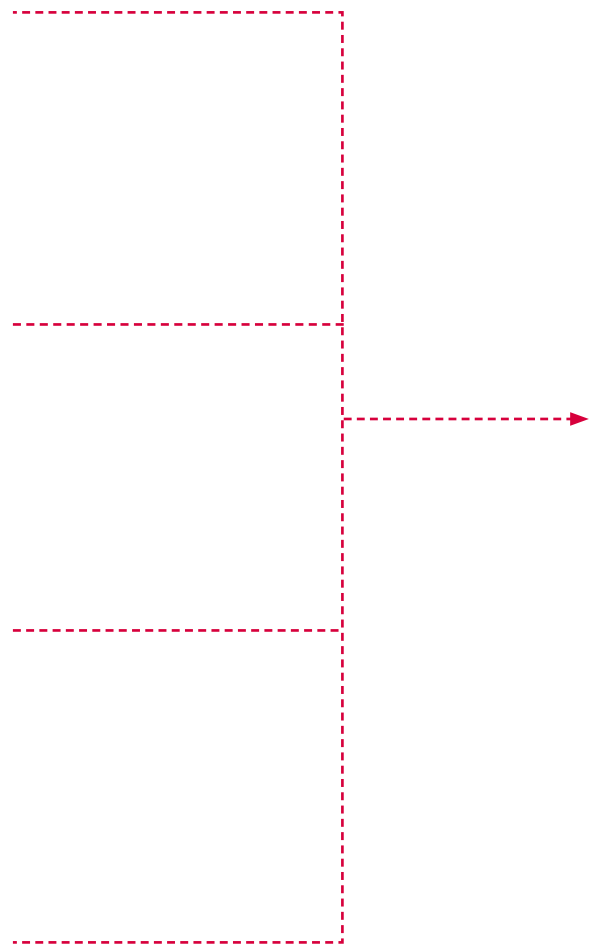



Cable gland set, consisting of a seal insert with multiple perforations and a closed seal insert.



DIN rail



Power unit and switch



Patch panel for RJ45 or OWG modules



OWG splice cassette



Strain relief strip



AMAXX® receptacle combination

Application examples

For local networks in any environment.

Dusty areas: Computer-monitored sawmill

AMAXX® network enclosure 260 x 225 mm (H x W) with 3 RJ45 data port receptacles BTR V4 stiffener wall (IP 67), e.g. for connecting PCs.
AMAXX® receptacle combination 130 x 225 mm (H x W) with 2 SCHUKO® receptacles and fuse, e.g. for PC power supply and surveillance monitors.



AMAXX network enclosure for safe installation in dusty areas.



AMAXX network enclosure for safe installation in humid areas.

Humid areas: Air conditioned greenhouse

AMAXX® network enclosure 260 x 225 mm (H x W) with 2 Cepex RJ45 data port receptacles (IP 44), e.g. for data connection of laptops and telephones.
AMAXX® receptacle combination 260 x 225 mm (H x W) with 3 SCHUKO® receptacles and fuses, e.g. for power supply of laptops and electric tools.

Rough operating environment:**Machining industry**

XXL network enclosure 520 x 260 mm (H x W) with a Cepex data port receptacle 2 x RJ45 and a Cepex data port receptacle 2 x ST modules (OWG), for connecting measuring equipment in the test field. An integrated SCHUKO® receptacle supplies the power for network revision.

Top section: Power supply stiffener wall.

Bottom section: Splice cassette with 6 OWG connectors E2000 (DIAMOND), 1 stiffener wall for protecting the OWG fibres from contact.

Fast installation of devices with pre-mounted network installation kit with DIN rails and stiffener walls. Due to its universal design and the generous installation depth, the XXL network enclosure allows the installation of varied network components.

With its protection degree up to IP 67 and the impact resistant enclosure, the network can also be installed fast and safely in extreme environments!



XXL network enclosure with many different installation options.

Cepex data port receptacles

Robust
and
variable.

The right choice for control stations, storage areas, laboratories, airports, production lines, etc. Cepex data port receptacles are operated with standard patch cables and can be combined with Cepex CEE and/or SCHUKO® receptacles. For wall-/panel mounting or installation in cable ducts.

Suitable for double
RJ45 ports, cat. 3 to
cat. 6.

The bottom part of the
enclosure can be turned by
180 degrees, which allows
cable insertion from above
or below without additional
work.



Safe:

Lockable even with con-
nected cables. The safety
lock prevents unauthorized
access. Identical locks are
available on request.



Simple:

All types are equipped with
a membrane gland fitting
M25 for two cables 3-9 mm.
Simply push in the cable –
done!



Visible labeling field.

Protection type IP 44 with closed cover or with plug inserted.



Spacious:

Spaciously dimensioned wiring space for fast and easy installation. The handcraft-conform construction protects the installed components.



Extra:

A metric cable gland M25 / 2 x 8 is optionally available for special requirements.

MENNEKES Industrial Ethernet – Energy and data.

Network enclosures AMAXX®

AMAPLAST® enclosure, protection class IP 67, bottom part black, top part grey RAL 7035 or yellow RAL 1021, bottom part with screw-in nuts for installation of a floor-mounted base including a height-adjustable mounting rail with mounting rail catches as well as a cable gland set with multiple seal.

	<p>Enclosure size: 130 x 225 mm Closed top part</p> <p>Cable entries: 2 x M25 top (open on the left, closed on the right), 2 x M25 bottom (closed), 2 x M20 each top and bottom (closed)</p> <p>Part no. 25100 grey Part no. 25100GE yellow</p>		<p>Enclosure size: 130 x 225 mm Top with transparent hinged window without protective cover (10 modules)</p> <p>Cable entries: 2 x M25 top (open on the left, closed on the right), 2 x M25 bottom (closed), 2 x M20 each top and bottom (closed)</p> <p>Part no. 25101 grey Part no. 25101GE yellow</p>
	<p>Enclosure size: 260 x 225 mm Closed top part</p> <p>Cable entries: 2 x M32 top (open on the left, closed on the right), 2 x M32 bottom (closed), 2 x M20 each top and bottom (closed)</p> <p>Part no. 25200 grey Part no. 25200GE yellow</p>		<p>Enclosure size: 260 x 225 mm Top with transparent hinged window without protective cover (10 modules)</p> <p>Cable entries: 2 x M32 top (open on the left, closed on the right), 2 x M32 bottom (closed), 2 x M20 each top and bottom (closed)</p> <p>Part no. 25201 grey Part no. 25201GE yellow</p>
	<p>Enclosure size: 390 x 225 mm Closed top part</p> <p>Cable entries: 2 x M40 top (open on the left, closed on the right), 2 x M40 bottom (closed), 2 x M20 each top and bottom (closed)</p> <p>Part no. 25300 grey Part no. 25300GE yellow</p>		<p>Enclosure size: 390 x 225 mm Top with transparent hinged window without protective cover (10 modules)</p> <p>Cable entries: 2 x M40 top (open on the left, closed on the right), 2 x M40 bottom (closed), 2 x M20 each top and bottom (closed)</p> <p>Part no. 25301 grey Part no. 25301GE yellow</p>
	<p>Enclosure size: 520 x 225 mm Closed top part</p> <p>Cable entries: 2 x M40 top (open on the left, closed on the right), 2 x M40 bottom (closed), 2 x M20 each top and bottom (closed)</p> <p>Part no. 25400 grey Part no. 25400GE yellow</p>		<p>Enclosure size: 520 x 225 mm Top with transparent hinged window without protective cover (10 modules)</p> <p>Cable entries: 2 x M40 top (open on the left, closed on the right), 2 x M40 bottom (closed), 2 x M20 each top and bottom (closed)</p> <p>Part no. 25401 grey Part no. 25401GE yellow</p>

Module board with 3 data port receptacles BTR V6 E-DAT

Module board with 3 data port receptacles BTR V4 bulkhead

Module board with 2 data port receptacles Cepex

Module board with 3 data port receptacles Harting type Han 3A



■ For further information about our products, please visit our website: www.MENNEKES.de

	<p>Module board AMAXX® equipped with 2 Cepex data port receptacles IP 44 each for 2 BTR E-DAT modules RJ45 Delivery scope: without data modules</p> <p>Part no. 25033 grey Part no. 253033GE yellow</p> <p>Part no. 25044 (grey module board with black data receptacles)</p>		<p>Data module for Cepex data port receptacles RJ45 connection module type E-DAT module connector 8(8) 90°, cat. 6 (recommended for improved cable routing)</p> <p>Part no. 25042</p>
	<p>Module board AMAXX® equipped with 3 data port receptacles BTR V4 bulkhead IP 67 (suited for RJ45 and OWG inserts by BTR, Telegärtner and Weidmüller) Delivery scope: without data modules</p> <p>Part no. 25034 grey Part no. 25034GE yellow</p>		<p>Data module for BTR Industry V4 bulkhead data port receptacle RJ45 connection module type BTR E-DAT Industry RJ45 connector insert, cat. 6</p> <p>Part no. 25037</p>
	<p>Module board AMAXX® equipped with 3 data port receptacles BTR E-DAT V6 8(8) EBM IP 67 (for installation of RJ45 or OWG data modules) Delivery scope: without data modules</p> <p>Part no. 25035 grey Part no. 25035GE yellow</p>		<p>Data module for BTR E-DAT V6 data port receptacle also suited for Cepex data port receptacle (order no. 25033) RJ45 connection module type E-DAT module connector 8(8), cat. 6</p> <p>Part no. 25038</p>
	<p>Module board AMAXX® equipped with 3 data port receptacles HARTING RJ45, type Han 3A, IP 67 metal design, straight model with self-closing cover Delivery scope: with data modules RJ45, cat. 5 / class D up to 100 MHz</p> <p>Part no. 25036 grey Part no. 25036GE yellow</p>		<p>XXL cable gland set M40, grey 1 screw connection M40, 1 counter nut, 1 multi-seal with 7 openings for cable diameters from 5 to 7 mm and 6 blind plugs, 1 seal (perforation by the customer)</p> <p>Part no. 25026</p>
	<p>Transparent window without protective cover (10 modules) for AMAXX® enclosure</p> <p>Part no. 25009</p>		<p>AMAXX® cable gland set, black 1 screw gland 1 multi-seal with openings for cable diameters from 5 to 7 mm and blind plugs 1 seal (perforation by the customer)</p> <p>Part no. 25023 M25 Part no. 25024 M32 Part no. 25025 M40</p>
	<p>AMAXX® screw set consisting of 4 screws (6 x 70 mm) and 4 dowels (8 x 50 mm)</p> <p>Part no. 990606</p> <p>Bargain: In the introduction phase free of charge with every network enclosure</p>		<p>Cable gland M20, black Part no. 990607</p> <p>Cable gland M32, black Part no. 990608</p> <p>Cable gland M40, black Part no. 990609</p>

MENNEKES Industrial Ethernet – Energy and data

Network components

	<p>Patch panel for installation on a DIN rail, fits all AMAXX® and XXL network enclosures including front panel for insertion of max. 8 RJ45 modules made by BTR (E-DAT module 8(8) jack) Rutenbeck (UM real. cat. 6a, B) Dätwyler (Unilan RJ45 module MS-N 1/8 cat. 6a) Material: Powder-coated sheet steel Colour: black Dimensions (W x H x D): 180 x 57 x 76 mm</p> <p>Part no. 25001</p>		<p>Height-adjustable DIN rail for 10 modules with 2 DIN rail notches for AMAXX® network enclosures</p> <p>Notice: 1 piece in each AMAXX® network enclosure equipped as standard</p> <p>Part no. 999040</p>
	<p>Patch panel for installation on a DIN rail, fits all AMAXX® and XXL network enclosures including front panel for insertion of max. 8 RJ45 modules made by CORNING (FutureCOM) Material: Powder-coated sheet steel Colour: black Dimensions (W x H x D): 180 x 57 x 76 mm</p> <p>Part no. 25002</p>		<p>Floor installation base for all AMAXX® enclosures as of an enclosure size of 260 x 225 mm Dimensions (W x H): 130 x 166 mm</p> <p>Part no. 990600</p>
	<p>Patch panel for installation on a DIN rail, fits all AMAXX® and XXL network enclosures including front panel for insertion of max. 8 ST/SC-D connectors Material: Powder-coated sheet steel Colour: black Dimensions (W x H x D): 180 x 57 x 76 mm</p> <p>Part no. 25003</p>		<p>Floor installation base for all AMAXX® enclosures as of an enclosure size of 260 x 225 mm Dimensions (W x H): 230 x 166 mm</p> <p>Part no. 990601</p>
	<p>OWG splice cassette for installation on a DIN rail, fits all AMAXX® and XXL network enclosures consisting of: 1 splice cassette for max. 12 individual splices incl. cover, patch panel for insertion of 6 ST/SC-D connectors 2 cable guide clips Dimensions (W x H x D): 193 x 53 x 101 mm</p> <p>Part no. 25004</p>		
	<p>OWG splice cassette for installation on a DIN rail, fits all AMAXX® and XXL network enclosures consisting of: 1 splice cassette for max. 12 individual splices incl. cover 1 patch panel for insertion of 6 connectors each: SC-SIMPLEX, E2000 (LSH), E2000 KOMPAKT, LC-DUPLEX, 2 cable guide clips Dimensions (W x H x D): 193 x 53 x 101 mm</p> <p>Part no. 25012</p>		
	<p>Strain relief strip for installation on a DIN rail, fits all AMAXX® and XXL network enclosures Strain relief of the cables via cable strips</p> <p>Dimensions (W x H x D): 139.5 x 16 x 40 mm</p> <p>Part no. 25019</p>		

■ For further information about our products, please visit our website: www.MENNEKES.de



Switch EL 100-3TX-1FX-ST-MM
 Unmanaged industrial Ethernet layer 2 switch with 3 TX ports and 1 FX port, multimode fibre
 Brand: EKS
 powder-coated stainless steel enclosure
 Data rate 10/100 Megabit/s
 Operating temperature: -10°C up to +55°C
 Dimensions (W x H x D): 100 x 61 x 113 mm

Part no. 25028



FL Switch SF 8TX
 Unmanaged industrial Ethernet switch with 8 TX ports
 Brand: Phoenix Contact
 Data rate 10/100 Megabit/s
 Operating temperature: 0°C up to +60°C
 Dimensions (W x H x D): 135 x 30 x 103 mm

Part no. 25039



Switch EL 100U2-6TX-1FX-ST-MM
 Unmanaged industrial Ethernet layer 2 switch with 6 TX ports and 1 FX port, multimode fibre
 Brand: EKS
 powder-coated stainless steel enclosure
 Data rate 10/100 Megabit/s
 Operating temperature: -10°C up to +55°C
 Dimensions (W x H x D): 100 x 61 x 113 mm

Part no. 25030



FL Switch SF 7TX/FX ST
 Unmanaged industrial Ethernet switch with 7 TX ports and 1 FX port, multimode fibre
 Brand: Phoenix Contact
 Data rate 10/100 Megabit/s
 Operating temperature: 0°C up to +60°C
 Dimensions (W x H x D): 135 x 30 x 103 mm

Part no. 25040



Switch EL 100U2-6TX-2FX-ST-MM
 Unmanaged industrial Ethernet layer 2 switch with 6 TX ports and 2 FX ports, multimode fibre
 Brand: EKS
 powder-coated stainless steel enclosure
 Data rate 10/100 Megabit/s
 Operating temperature: -10°C up to +55°C
 Dimensions (W x H x D): 100 x 61 x 113 mm

Part no. 25031



FL Switch SF 6TX/2FX ST
 Unmanaged industrial Ethernet switch with 6 TX ports and 2 FX ports, multimode fibre
 Brand: Phoenix Contact
 Data rate 10/100 Megabit/s
 Operating temperature: 0°C up to +60°C
 Dimensions (W x H x D): 135 x 30 x 103 mm

Part no. 25041



Power unit and switch



Power unit
 24V DC-12W/0.5A
 Brand: Eltako, 1 TE
 Nominal voltage: 12W
 Dimensions: 18 mm wide, 58 mm deep
 Operating temperature: -10°C up to +50°C

Part no. 25032



DIN rail



Patch panel for RJ45 or OWG modules



SCHUKO® snap-in receptacle for fixing on DIN rail with fixing rack 11254

Part no. 11510K



OWG splice cassette



Fixing rack for fixing of SCHUKO® receptacles 11510K on DIN rails

Part no. 11254

Network enclosure XXL

AMAPLAST® enclosure, protection type IP 67, grey RAL 7035, including: a cable gland set with multiple seal; a mounted network installation kit consisting of: 1 base plate, aluminium, with 3 DIN rails, 1 DIN rail (snap), 1 stiffener wall small (fibre protection), 1 stiffener wall large (power unit), prepared for installation of network components



Enclosure size: 520 x 260 mm
 Top part hinged on the right
 Operating window with knurled screws, lockable with padlock
 Installation opening for series installation devices: 160 x 200 mm (H x W)
 Cable entries:
 2 x M40 top (open on the left, closed on the right)
 2 x M40 bottom (closed)

Part no. 25600



Alternative:
 With opening for 2 Cepex data port receptacles
 Protection type IP 44
 (Delivery scope: without Cepex data port receptacles)

Part no. 25601

Network enclosure XXL

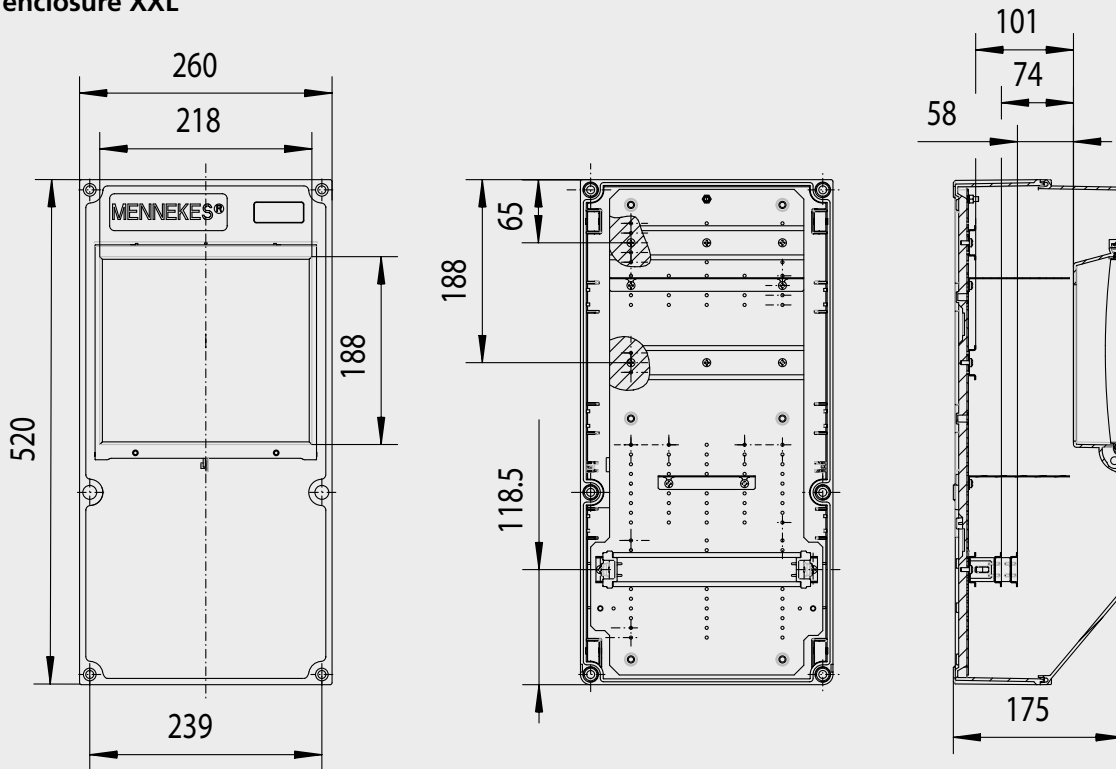

5MB47

Network enclosures AMAXX®

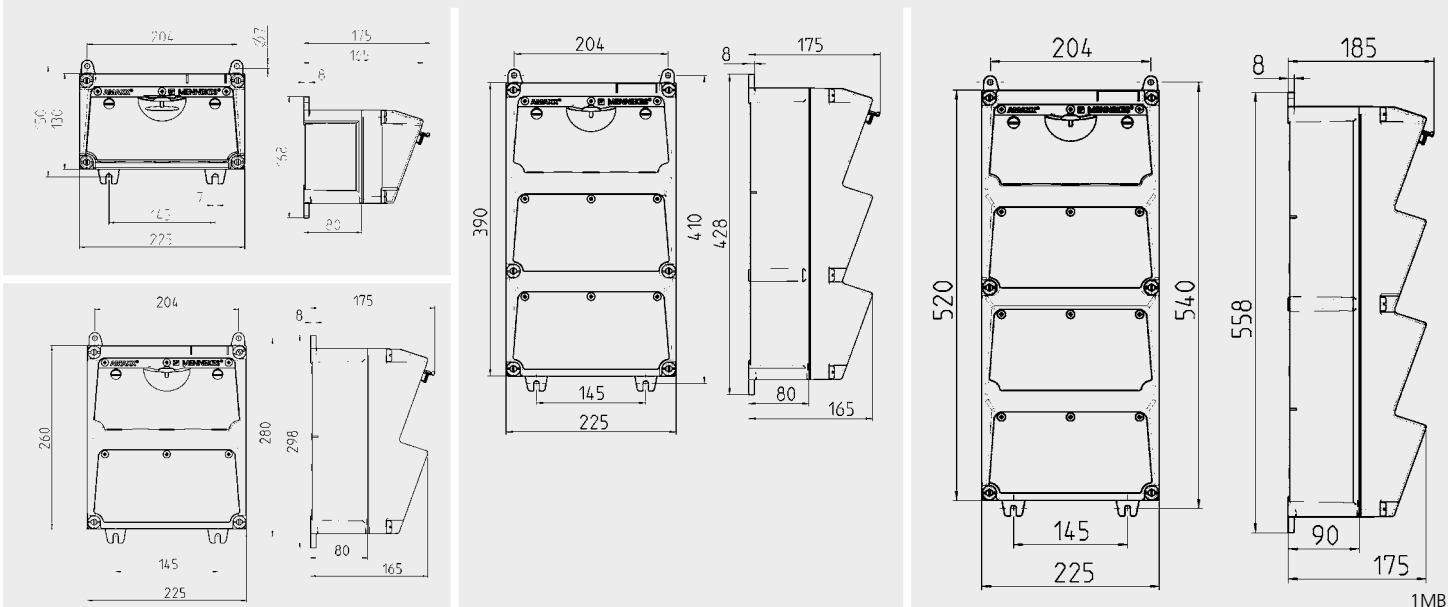

1MB532

■ Notice: For detailed dimensions refer to the respective part numbers on our website!

A selection of AMAXX® receptacle combinations

AMAPLAST® enclosure, protection type IP 44, bottom part black, top part grey RAL 7035 or yellow RAL 1021. Combination pre-wired for installation

Plugs for the world



Enclosure size: 130 x 225 mm

2 SCHUKO® receptacles 16A, 2p+E, 230V
2 MCB's 16A, 1p, C
1 RCD 25A, 2p, IFN = 0.03A

Cable entries:
2 x M25 top (open on the left, closed on the right),
2 x M25 bottom (closed),
2 x M20 each top and bottom (closed)

Part no. 910001 **grey**
Part no. 910001GE **yellow**



Enclosure size: 130 x 225 mm

3 SCHUKO® receptacles 16A, 2p+E, 230V

Cable entries:
2 x M25 top (open on the left, closed on the right),
2 x M25 bottom (closed),
2 x M20 each top and bottom (closed)

Part no. 910005 **grey**
Part no. 910005GE **yellow**



Enclosure size: 260 x 225 mm

3 SCHUKO® receptacles 16A, 2p+E, 230V
3 MCB's 16A, 1p, C
1 RCD 40A, 4p, IFN = 0.03A

Cable entries:
2 x M32 top (open on the left, closed on the right),
2 x M32 bottom (closed),
2 x M20 each top and bottom (closed)

Part no. 920003 **grey**
Part no. 910003GE **yellow**



Enclosure size: 260 x 225 mm

1 CEE receptacle 32A, 5p, 400V
1 MCB 32A, 3p, C
2 SCHUKO® receptacles 16A, 2p+E, 230V
2 MCB's 16A, 1p, C
1 RCD 40A, 4p, IFN = 0.03A

Cable entries:
2 x M32 top (open on the left, closed on the right),
2 x M32 bottom (closed),
2 x M20 each top and bottom (closed)

Part no. 920015 **grey**
Part no. 920015GE **yellow**



Enclosure size: 260 x 225 mm

1 CEE receptacle 16A, 5p, 400V
1 MCB 16A, 3p, C
2 SCHUKO® receptacles 16A, 2p+E, 230V
2 MCB's 16A, 1p, C

Cable entries:
2 x M32 top (open on the left, closed on the right),
2 x M32 bottom (closed),
2 x M20 each top and bottom (closed)

Part no. 920009 **grey**
Part no. 920009GE **yellow**



Enclosure size: 390 x 225 mm

1 CEE receptacle 32A, 5p, 400V
1 MCB 32A, 3p, C
1 CEE receptacle 16A, 5p, 400V
1 MCB 16A, 3p, C
2 SCHUKO® receptacles 16A, 2p+E, 230V
2 MCB's 16A, 1p, C
1 RCD 40A, 4p, IFN = 0.03A

Cable entries:
2 x M40 top (open on the left, closed on the right),
2 x M40 bottom (closed),
2 x M20 each top and bottom (closed)

Part no. 930013 **grey**
Part no. 930013GE **yellow**

These illustrations are just some examples of possible configurations. Compile your individual combination based on the AMAXX® energy enclosures. Further information is included in the brochure "AMAXX®". Or use the AMAXX® online configurator for fast and easy configuration: www.AMAXX.info.

MENNEKES Cepex data port receptacles and accessories

Colours: grey (RAL 7035), alpine white (RAL 9010), silver (RAL 9006)
Enclosure and insert made of AMAPLAST®

	<p>Cepex enclosures as wall mounted receptacle for installation of RJ45 data port receptacles, 2 keys, grey RAL 7035 IP 44,</p> <p>⚠ IP 44, Product group 1024 type 4300 shown</p>	<table border="1"> <thead> <tr> <th>Brand</th> <th>Type</th> <th>Part no./grey</th> </tr> </thead> <tbody> <tr> <td>AMP</td> <td>Twist</td> <td>4350</td> </tr> <tr> <td>AMP</td> <td>Jack</td> <td>4360</td> </tr> <tr> <td>AMP</td> <td>CO Plus</td> <td>4370*</td> </tr> <tr> <td>BTR</td> <td>E-DAT module</td> <td>4340</td> </tr> <tr> <td>Rutenbeck</td> <td>UPOS</td> <td>4320</td> </tr> <tr> <td>TKM</td> <td>KDMS</td> <td>4300</td> </tr> </tbody> </table> <p>Packaging unit: 5 pieces, weight 284g/piece With identical locks: Part no. + index "G"</p>	Brand	Type	Part no./grey	AMP	Twist	4350	AMP	Jack	4360	AMP	CO Plus	4370*	BTR	E-DAT module	4340	Rutenbeck	UPOS	4320	TKM	KDMS	4300	<p>* The data inserts/modules AMP CO Plus are not part of the MENNEKES delivery program!</p>
Brand	Type	Part no./grey																						
AMP	Twist	4350																						
AMP	Jack	4360																						
AMP	CO Plus	4370*																						
BTR	E-DAT module	4340																						
Rutenbeck	UPOS	4320																						
TKM	KDMS	4300																						
	<p>Cepex enclosures as panel mounted receptacle for installation of RJ45 data port receptacles, 2 keys, grey RAL 7035 IP 44,</p> <p>⚠ IP 44, Product group 1020 type 4302 shown</p>	<table border="1"> <thead> <tr> <th>Brand</th> <th>Type</th> <th>Part no./grey</th> </tr> </thead> <tbody> <tr> <td>AMP</td> <td>Twist</td> <td>4352</td> </tr> <tr> <td>AMP</td> <td>Jack</td> <td>4362</td> </tr> <tr> <td>AMP</td> <td>CO Plus</td> <td>4372*</td> </tr> <tr> <td>BTR</td> <td>E-DAT module</td> <td>4342</td> </tr> <tr> <td>Rutenbeck</td> <td>UPOS</td> <td>4322</td> </tr> <tr> <td>TKM</td> <td>KDMS</td> <td>4302</td> </tr> </tbody> </table> <p>Packaging unit: 5 pieces, weight 170 g/piece With identical locks: Part no. + index "G"</p>	Brand	Type	Part no./grey	AMP	Twist	4352	AMP	Jack	4362	AMP	CO Plus	4372*	BTR	E-DAT module	4342	Rutenbeck	UPOS	4322	TKM	KDMS	4302	
Brand	Type	Part no./grey																						
AMP	Twist	4352																						
AMP	Jack	4362																						
AMP	CO Plus	4372*																						
BTR	E-DAT module	4342																						
Rutenbeck	UPOS	4322																						
TKM	KDMS	4302																						
	<p>Cepex enclosures as panel mounted receptacle for installation of RJ45 data port receptacles, 2 keys, alpine white RAL 9010</p> <p>⚠ IP 44, Product group 1020 type 4304 shown</p>	<table border="1"> <thead> <tr> <th>Brand</th> <th>Type</th> <th>Part no./alpine white</th> </tr> </thead> <tbody> <tr> <td>AMP</td> <td>Twist</td> <td>4354</td> </tr> <tr> <td>AMP</td> <td>Jack</td> <td>4364</td> </tr> <tr> <td>AMP</td> <td>CO Plus</td> <td>4374*</td> </tr> <tr> <td>BTR</td> <td>E-DAT module</td> <td>4344</td> </tr> <tr> <td>Rutenbeck</td> <td>UPOS</td> <td>4324</td> </tr> <tr> <td>TKM</td> <td>KDMS</td> <td>4304</td> </tr> </tbody> </table> <p>Packaging unit: 5 pieces, weight 170 g/piece With identical locks: Part no. + index "G"</p>	Brand	Type	Part no./alpine white	AMP	Twist	4354	AMP	Jack	4364	AMP	CO Plus	4374*	BTR	E-DAT module	4344	Rutenbeck	UPOS	4324	TKM	KDMS	4304	
Brand	Type	Part no./alpine white																						
AMP	Twist	4354																						
AMP	Jack	4364																						
AMP	CO Plus	4374*																						
BTR	E-DAT module	4344																						
Rutenbeck	UPOS	4324																						
TKM	KDMS	4304																						
	<p>Cepex enclosure as panel mounted receptacle for installation of RJ45 data port receptacles, 2 keys, silver RAL 9006</p> <p>⚠ IP 44, Product group 1020 type 4326 shown</p>	<table border="1"> <thead> <tr> <th>Brand</th> <th>Type</th> <th>Part no./silver</th> </tr> </thead> <tbody> <tr> <td>Rutenbeck</td> <td>UPOS</td> <td>4326</td> </tr> </tbody> </table> <p>Packaging unit: 5 pieces, weight 170 g/piece With identical locks: Part no. + index "G"</p>	Brand	Type	Part no./silver	Rutenbeck	UPOS	4326																
Brand	Type	Part no./silver																						
Rutenbeck	UPOS	4326																						
	<p>Back box suitable for Cepex panel mounted receptacles (= flush mounted receptacles)</p> <p>⚠ IP 44, Product group 8236 type 41404 shown Packaging unit: 5 pieces Weight 78g/piece</p> <p>Part no. 41404</p>																							
	<p>Spacer frame as a height equalizer, matching all wall mounted Cepex receptacles</p> <p>Packaging unit: 25 pieces</p> <p>Part no. 4191 grey Part no. 41915 black</p>		<p>Cable gland M25 / 2 x 8, for 2 cables 3–8 mm, matching all Cepex wall mounted receptacles, grey RAL 7035</p> <p>Packaging unit: 25 pieces</p> <p>Part no. 41453</p>																					

■ For further information about our products, please visit our website: www.MENNEKES.de

Data port inserts / Modules for Cepex wall- and panel mounted receptacles



Brand: AMP
Type: Data port insert, 2 x RJ45, cat. 6,
(type AMP Twist Dual/Outlet)
Packaging unit: 10 pieces

Required accessories:
See last position

Part no. 41456



Brand: Rutenbeck
Type: Data port insert, 2 x RJ45, cat. 6,
(type UP05)
Packaging unit: 10 pieces

Required accessories:
See last position

Part no. 41451



Brand: AMP
Type: RJ45 connection module,
(type cat. 6 SL Jack)
Packaging unit: 10 pieces

Required accessories from AMP
(2 modules per enclosure)

Part no. 41457



Brand: BTR
Type: RJ45 connection module, (type E-DAT
module 8(8) jack, cat. 6)
Packaging unit: 10 pieces
Required accessories for BTR-E-DAT
Module for cable duct and DIN rail installati-
on: installation support for T-nut and DIN rail
attachment, fits BTR (2 modules per enclosure),
BTR-No. 1308895521-I

Part no. 41454



Brand: TKM
Type: Data port insert,
2 x RJ45, cat. 6),
(type KDMF)
Packaging unit: 10 pieces

Required accessories: See last position

Part no. 41452

Required accessories for cable duct installation for AMP (type TWIST) Rutenbeck and TKM data port inserts:
installation box, Tehalit part no. L 5819 and blind 100 mm channel height, single,
Tehalit part no. L 9120 or blind 120 mm channel height, single, Tehalit part no. L 9170

Contact persons

Günter Hecht

Tel. +49 (0) 27 23 / 41-310
Fax +49 (0) 27 23 / 41-49 310
gunter.hecht@MENNEKES.de



Dr. Sandra Feldmann

Tel. +49 (0) 27 23 / 41-425
Fax +49 (0) 27 23 / 41-49 425
sandra.feldmann@MENNEKES.de



Thomas Hinz

Tel. +49 (0) 27 23 / 41-391
Fax +49 (0) 27 23 / 41-49 391
thomas.hinz@MENNEKES.de



Thomas Herbig

Tel. +49 (0) 27 23 / 41-342
Fax +49 (0) 27 23 / 41-49 342
thomas.herbig@MENNEKES.de





MENNEKES®

Plugs for the world

MENNEKES
Elektrotechnik GmbH & Co. KG
Spezialfabrik für Steckvorrichtungen

Aloys-Mennekes-Str. 1
D-57399 Kirchhundem

Tel. +49 (0) 27 23 / 41-1
Fax +49 (0) 27 23 / 41-2 14
E-Mail info@MENNEKES.de
Internet www.MENNEKES.de

Refer to our brochures and catalogues to keep up to date.
Download the latest versions from our website in practical
PDF format or request print copies by phone or E-Mail.



AMAXX®.
A new approach to receptacle combinations.



Screwless connections.
For CEE plugs, connectors and receptacles.

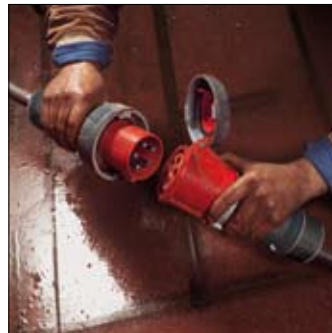

PowerTop® Xtra.
Plugs and connectors for toughest conditions.



MENNEKES catalogue.



Distributors.
For ceiling, wall and floor.
For energy, data, compressed air and light.



Stainless steel distributors.
Wind and weather proof.
Service stations for power and water.
Save operation at any time of a year.



Event and entertainment technology.
Plugs and receptacles for stage, TV, radio and open air events.

For further information please visit our website:

www.MENNEKES.de

Request brochures by phone at:

+49 (0) 27 23 / 41-1

Request brochures by E-Mail to:

service@MENNEKES.de

**Service by
MENNEKES®.**
Always well informed.